

Cordless Impact Wrench series



TW010G

3,150 N·m

Square drive size
1" (25.4mm)

- M27 - 45
- M20 - 33



TW001G

1,800 N·m

Square drive size
3/4" (19mm)

- M12 - 36
- M10 - 27



TW007G / TW008G

760 N·m

Square drive size
1/2" (12.7mm)

- M10 - 24
- M10 - 16



TW004G / TW005G

350 N·m

Square drive size
1/2" (12.7mm)

- M10 - 20
- M10 - 16



Accessories

Impact socket with O-ring and pin



Size (mm)	Part No	Size (mm)	Part No
27 x 60	E-24511	42 x 68	E-24608
30 x 62	E-24527	44 x 70	E-24614
32 x 63	E-24533	46 x 72	E-24620
33 x 63	E-24549	50 x 76	E-24636
34 x 63	E-24555	55 x 84	E-24642
36 x 66	E-24561	60 x 88	E-24658
38 x 66	E-24577	65 x 92	E-24664
40 x 66	E-24583	70 x 96	E-24670
41 x 68	E-24599		

Impact deep socket with O-ring and pin



Size (mm)	Part No	Size (mm)	Part No
27 x 90	E-24686	44 x 90	E-24767
30 x 90	E-24692	46 x 100	E-24773
32 x 90	E-24701	50 x 100	E-24789
33 x 90	E-24717	55 x 108	E-24795
34 x 90	E-24723	60 x 108	E-24804
36 x 90	E-24739	65 x 120	E-24810
38 x 90	E-24745		
40 x 90	E-24751		
41 x 90	E-22420		

O ring

E-22436



Pin

E-22442



Charging Time

Battery	Fast Charging	
	DC40RA	DC40RC
BL4040 4.0Ah	45 min	67 min
*1 BL4040F 4.0Ah	45 min	67 min
*1 BL4050F 5.0Ah	50 min	85 min
*1 BL4080F 8.0Ah	76 min	170 min

*1 Recommended battery

Cordless Impact Wrench		
TW010G 1" (25.4 mm)		
	Variable Speed	Square drive 25.4 mm (1") Anvil length 163 mm (6-3/8") Max fastening torque 3,150 N·m (2,323 ft.lbs.) Fastening torque Max / Hard / Med. / Soft: 2,850 / 1,600 / 1,000 / 600 N·m (2,100 / 1,180 / 740 / 440 ft.lbs.)
	Brake	
	Reversing	
	Electronic 4-Speed	Nut-busting torque 4,000 N·m (2,950 ft.lbs.) Fastening capacities Standard bolt: M27 - M45 (1-1/8 - 1-7/8") High strength bolt: M20 - M33 (3/4 - 1-3/8")
	Built-in Job Light	No load speed Max / Hard / Med. / Soft: 0 - 1,200 / 0 - 850 / 0 - 700 / 0 - 600 min ⁻¹ Impacts per minute (IPM) Max / Hard / Med. / Soft: 0 - 1,750 / 0 - 1,500 / 0 - 1,300 / 0 - 1,200
	Sound pressure level	103 dB(A)
	Sound power level	111 dB(A)
	Noise K factor	3 dB(A)
	Vibration level	33.4 m/s ²
	Vibration K factor	1.6 m/s ²
	Dimensions(L x W x H)	w/ BL4050F: 570 x 135 x 297 mm (22-1/2 x 5-5/16 x 11-3/4")
	Net weight	12.0 - 12.9 kg (26.5 - 28.4 lbs.)
	Net weight (Battery)	BL4040F - BL4080F

Standard Equipment : Side handle, Tool hanger (Ring), Battery, Charger

The weight may differ depending on the attachment(s), including the battery cartridge.
Items of standard equipment and specifications may vary by country or area.

Makita Corporation

3-11-8 Sumiyoshi-cho, Anjo, Aichi, 446-8502 Japan

PRINTED IN JAPAN 202410



www.makita.com

1" (25.4mm) square

Max. fastening torque

3,150 N·m

6 seconds after seating, when tightening



Nut-busting torque

4,000 N·m

within 3 seconds, when loosening



High power
Brushless motor

BL
MOTOR

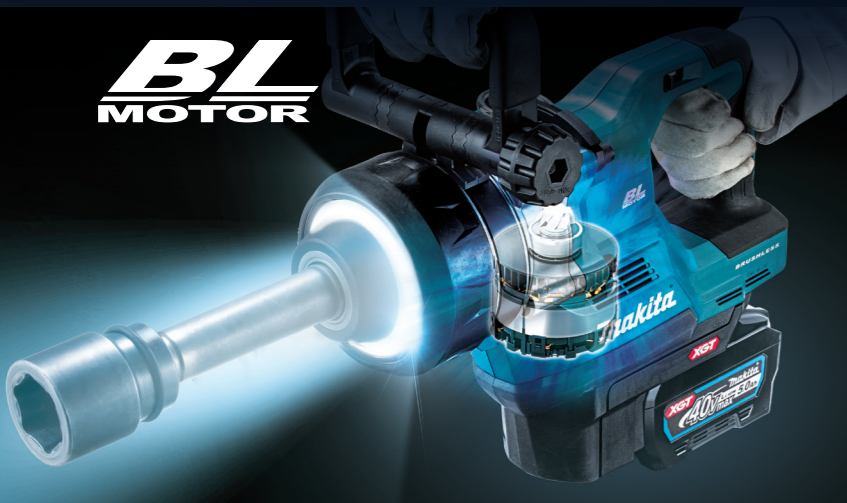

Compact **570 mm***



*Overall length, with BL4050F

Ring illumination LED

Reduces the shadow of the socket on a workpiece, providing a better view of the workpiece.



Toolless installation of Side handle

Side handle can be installed 360° without a tool, and the angle of the holding section can be adjusted back and forth, making it suitable for a variety of operations.



For tightening large diameter bolts

1" (25.4mm) square

Max. fastening torque
3,150 N·m

6 seconds after seating, when tightening

Nut-busting torque
4,000 N·m

within 3 seconds, when loosening

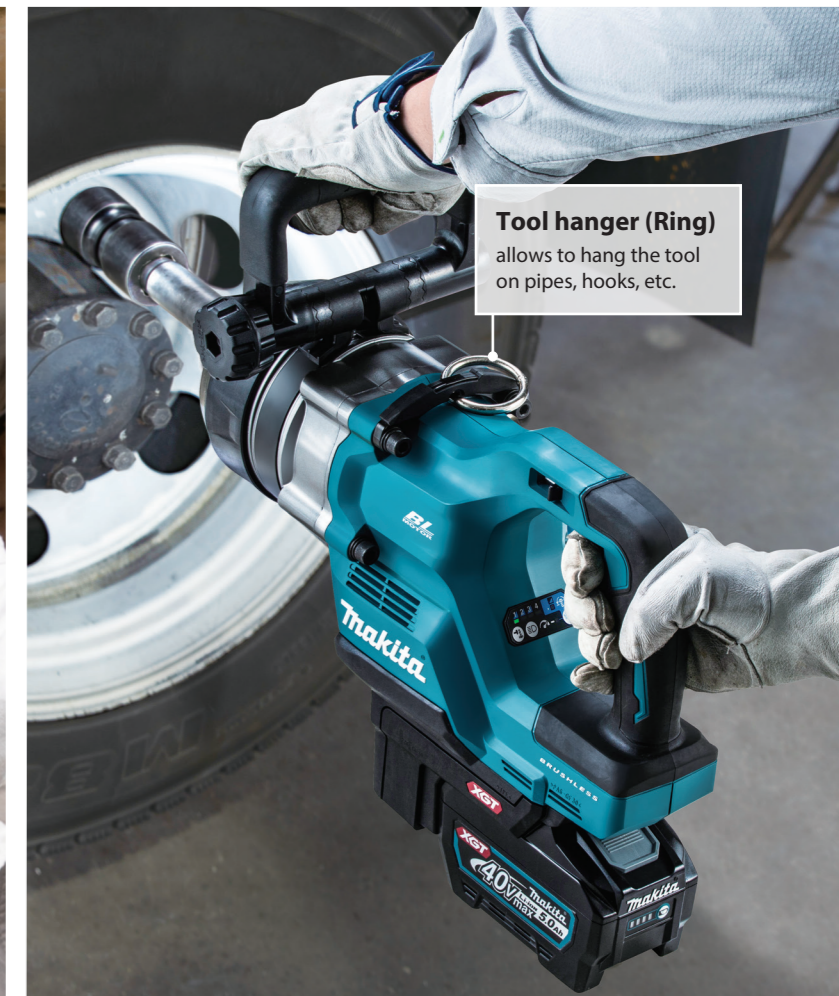

Tool hanger (Ring)
allows to hang the tool on pipes, hooks, etc.

XPT

(eXtreme Protection Technology)

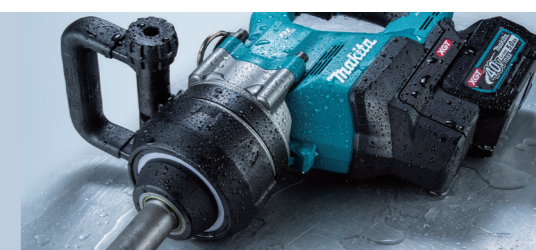

Auto-stop system available in both forward / reverse rotation modes

3 modes of reaction time for automatic stop available both in forward and reverse rotation modes.

	Forward	Reverse
mode 1	At impact power 2, the tool stops automatically as soon as it has detected the first impact blow.	At impact power 4, the tool stops automatically as soon as it has stopped impact blow.
mode 2	At impact power 3, the tool stops automatically approximately 0.5 seconds after the moment it has detected the first impact blow.	At impact power 4, the tool stops automatically approximately 0.2 seconds after the moment it has stopped impact blow.
mode 3	At impact power 4, the tool stops automatically approximately 1.0 second after the moment it has detected the first impact blow.	At impact power 4, the tool automatically slows down after the moment it has stopped impact blow.

With regard to the reverse rotation mode (for loosening), the reaction time is set at the maximum impact power 4, which is the maximum capacity, because no adjustment of impact power is required for the mode.

Electronic 4 stage impact power selection

Both in forward and reverse rotation modes, max (4) / hard (3) / medium (2) / soft (1) impact power can be selected to suit the material of workpiece or bolt type simply by pushing the button.

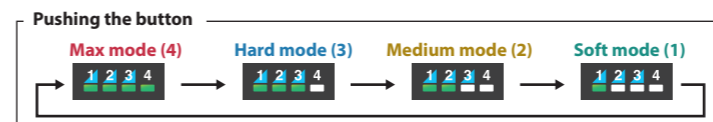

Mode	Max mode (4)	Hard mode (3)	Medium mode (2)	Soft mode (1)
Fastening torque (N·m)*1	2,850	1,600	1,000	600
No load speed (min ⁻¹)	0-1,200	0-850	0-700	0-600
Impacts per minutes (min ⁻¹)	0-1,750	0-1,500	0-1,300	0-1,200

*1 3 seconds after seating, when tightening

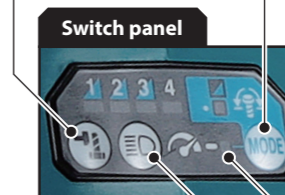

Ring illumination LED switch
With preglow/afterglow functions and light mode

Full speed mode lamp

Full speed mode button (Variable speed / Full speed)

- Full speed is reached with less trigger pull, reducing fatigue in continuous operation.
- Variable speed mode or Full speed mode can be selected depending on applications.

