



Cordless Jig Saw DJV185 / DJV184

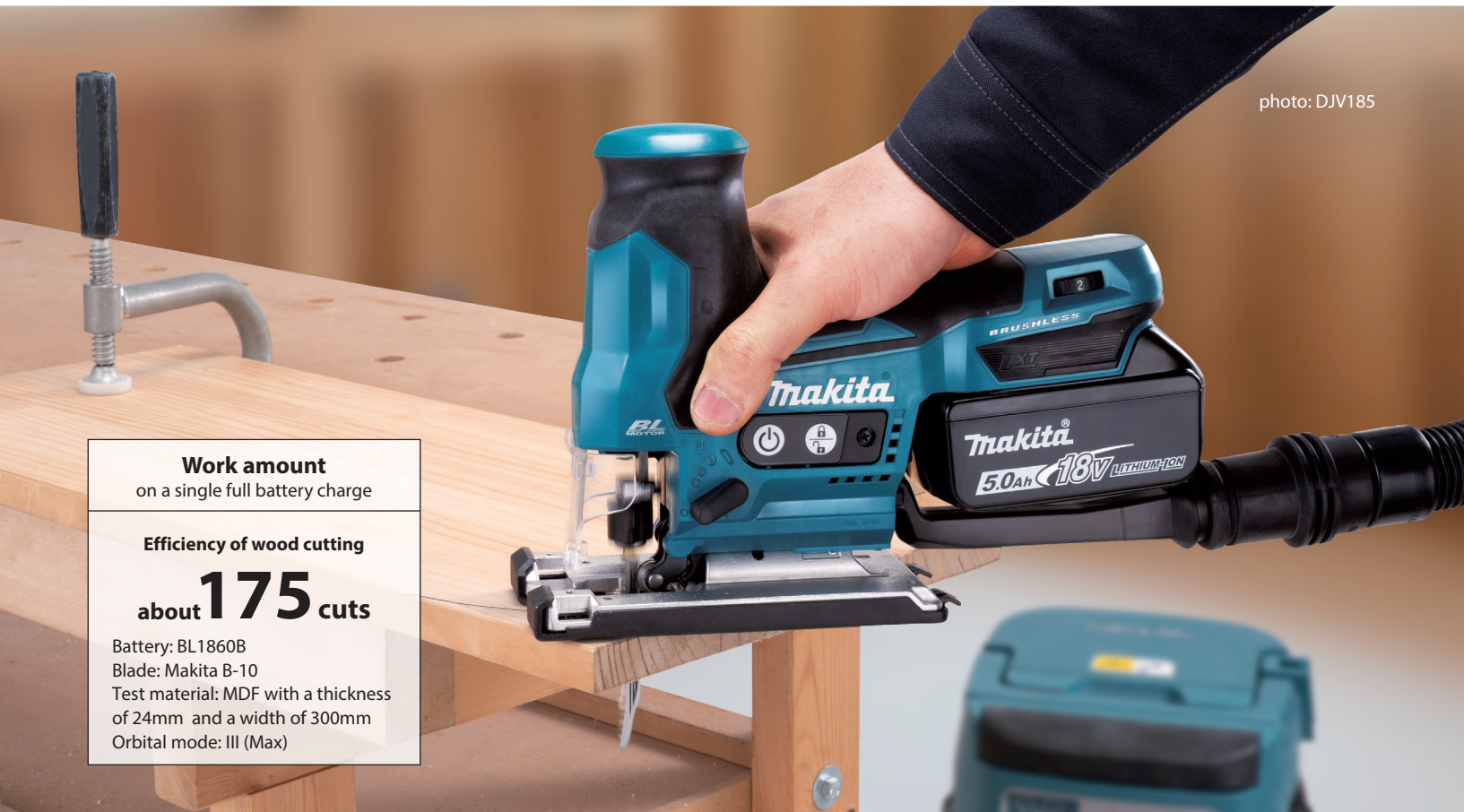

photo: DJV185

Work amount
on a single full battery charge

Efficiency of wood cutting
about **175** cuts

Battery: BL1860B
Blade: Makita B-10
Test material: MDF with a thickness of 24mm and a width of 300mm
Orbital mode: III (Max)



photo: DJV185



photo: DJV184

DJV185 new
Barrel handle type

Electronic push
button switch



DJV184
Top handle type

Trigger switch
with lock-on
button



Compact and Lightweight design



SOFT NO LOAD

(with disabling function)
Reduces vibration and aligns blade with the cutting line easily.

Strokes Per Minute [min⁻¹]

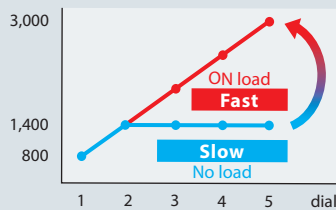

Light reduction function

DJV185 only
reduces the glare of the light when the tool is being used upside down.

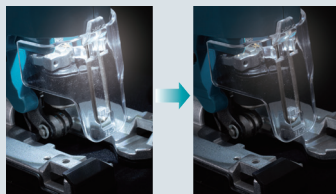

High efficiency

High efficiency achieved by widening the range of constant speed to reduce the chance of drop in cutting speed.

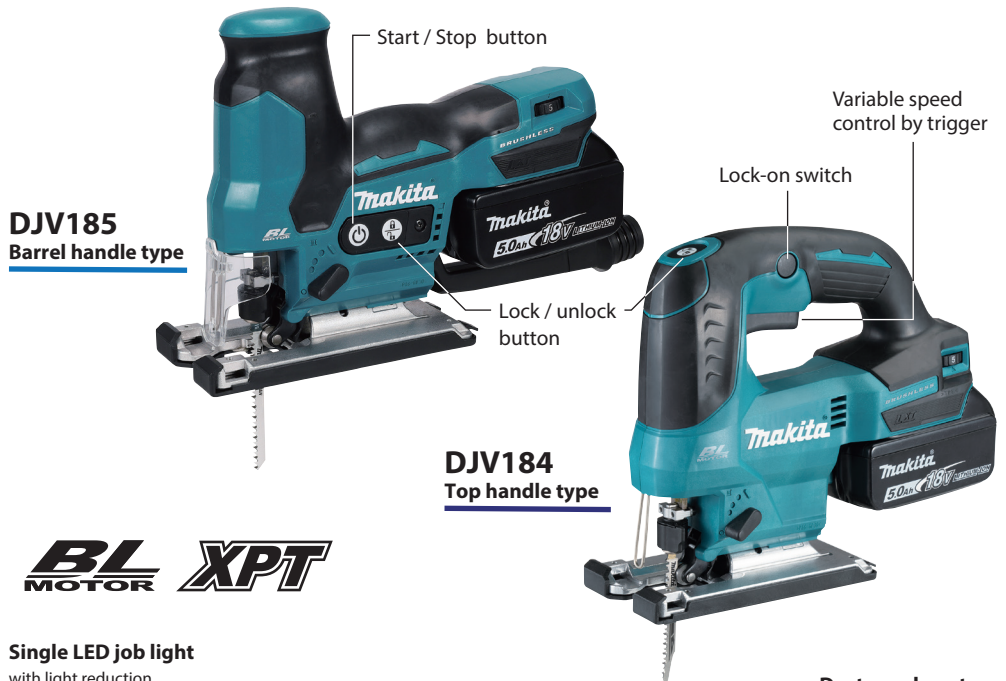

BL MOTOR XPT

Single LED job light

with light reduction function and light up function during standby mode



3 Orbital settings + Straight cutting



Variable speed control by dial



Toolless blade clamp



Dust nozzle not integrated with the tool's body



Accessories

Dust nozzle

Part No. 413F05-1



Dust cover

Part No. 458191-5



Cover plate

Part No. 457867-1



Anti-splitting device

Part No. 192557-6

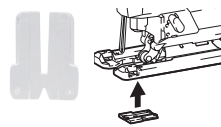

Guide rail adapter set

Part No. 198704-7



Guide rule set

Part No. 192732-4

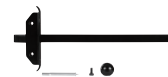

Guide rail

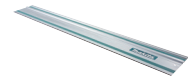

Overall length	Part No.
1m	199140-0
1.4m	194368-5
1.5m	199141-8
1.9m	194925-9
3m	194367-7

Charging Time

Model	Fast Charging	
	DC18RC	DC18SD
BL1815N 1.5Ah	15 min	30 min
BL1820B 2.0Ah	24 min	45 min
BL1830B 3.0Ah	22 min	60 min
BL1840B 4.0Ah	36 min	90 min
BL1850B 5.0Ah	45 min	110 min
BL1860B 6.0Ah	55 min	130 min

Cordless Jig Saw DJV185 / DJV184

- Variable Speed
- Brake
- Constant Speed
- Soft Start
- Orbital Cutting
- Bayonet Shank Jig Saw Blade
- Dust Collection
- Built-in Job Light
- Carrying Case

Capacity	Wood: 135 mm (5-5/16") / Mild steel: 10 mm (3/8") Aluminum: 20 mm (7/8")
Length of stroke	23 mm (7/8")
Strokes per minute (SPM)	DJV185: 800 - 3,000 DJV184: 0 - 3,000
Bevel range	0 - 45°
Vibration level	DJV185: Boards: 10.3 m/s ² / Sheet metal: 9.0 m/s ² DJV184: Boards: 7.4 m/s ² / Sheet metal: 5.1 m/s ²
Sound pressure level	DJV185: 84 dB (A) / DJV184: 82 dB (A)
Sound power level	DJV185: 95 dB (A) / DJV184: 93 dB (A)
Dimensions (L x W x H)	DJV185: 259 x 77 x 183 mm (10-1/4 x 3 x 7-1/4") DJV184: 259 x 77 x 205 mm (10-1/4 x 3 x 8-1/8")
Net weight	DJV185: 2.0 - 2.3 kg (4.4 - 5.1 lbs.) DJV184: 2.1 - 2.4 kg (4.6 - 5.3 lbs.)

Standard Equipment: Jig saw blade (country-specific), Hex wrench, Cover plate, Dust nozzle (country-specific), Dust cover (country-specific), Battery, Charger

The weight may differ depending on the attachment(s), including the battery cartridge. The lightest and heaviest combination, according to EPTA-Procedure 01/2014, are shown in the table. Items of standard equipment and specifications may vary by country or area.

Makita Corporation

3-11-8 Sumiyoshi-cho, Anjo, Aichi, 446-8502 Japan

PRINTED IN JAPAN 202303