

**Accessories**

**Plastic blade**

Cutting width	Plastic blade Set	Replacement plastic blade 12pcs. set
255mm	198383-1	198426-9

**Shoulder strap assembly**

For UR016G  
Comfort  
Part No.122A37-4



**Shoulder strap assembly**

For UR017G  
Single  
Part No.122D94-0



**Brushcutter blade**

	2-tooth blade	3-tooth blade	4-tooth blade
Blade dia			
230mm	197997-3	195298-3	195150-5

**Trimmer head**

Part No. 197296-3  
Cord/Line: 2.0mm  
Ref.: 90-M10L



Part No. 198893-8  
Cord/Line: 2.0mm  
Ref.: 95-M10L



Part No. 191D89-4  
Cord/Line: 2.0mm  
Ref.: 96-M10L



Part No. 196324-1  
Cord/Line: 2.4mm  
Ref.: UN-74L/  
100-M10L



**Four-leaf spiral nylon cord**

green Size	Part No.	orange Size	Part No.
2.0mmx15m	197471-1	2.4mmx15m	198501-1
	197472-9	2.4mmx30m	198502-9
2.0mmx30m	197473-7	2.4mmx120m	198503-7
2.0mmx160m	197474-5	2.4mmx180m	198504-5
2.0mmx280m	197475-3		

**Protector U 330 set**

Part No.1911X4-8



**Grease vessel set**

Part No.199450-5



**Charging Time**

	DC40RA	DC40RC
*1 BL4020 2.0Ah	22 min	30 min
*1 BL4025 2.5Ah	28 min	38 min
*1 BL4040 4.0Ah	45 min	67 min
*1 BL4050F 5.0Ah	50 min	85 min

\*1 Recommended battery

Cordless Grass Trimmer		UR016G / UR017G
	Brake	Cutting Width Metal blade: 230 mm (9") Nylon Cutting Head: 330 mm (13") Plastic Blade: 255 mm (10")
	Grass tangle removing function	No Load Speed (RPM) High / Med. / Low: 6,500 / 5,300 / 3,500
	Electronic 3-Speed	Spindle size M10 x 1.25 LH
	Constant Speed	Sound Pressure Level / Sound Power Level 2-Tooth Blade: 81.3 / 94.1 dB(A) Nylon Cutting Head: 82.2 / 92.3 dB(A) Plastic Blade: 81.8 / 90.5 dB(A)
	Soft Start	Vibration level Left / Right: 2.5 / 2.5 m/s <sup>2</sup> or less
		Dimensions (L x W x H) UR016G: 1,890 x 625 x 537 mm (74-1/2 x 24-5/8 x 21-1/8") UR017G: 1,890 x 362 x 265 mm (74-1/2 x 14-1/4 x 10-3/8")
		Net weight UR016G: 4.7 - 5.3 kg (10.4 - 11.7 lbs.) UR017G: 4.2 - 4.8 kg (9.3 - 10.6 lbs.)
	<b>Standard Equipment:</b>	Plastic blade, Nylon cutting head (country-specific), Shoulder strap, Box driver, Hex wrench, Accessory bag, Battery, Charger

The weight may differ depending on the attachment(s), including the battery cartridge. The lightest and heaviest combination, according to EPTA-Procedure 01/2014, are shown in the table. Items of standard equipment and specifications may vary by country or area.

**Makita Corporation**

3-11-8 Sumiyoshi-cho, Anjo, Aichi, 446-8502 Japan

PRINTED IN JAPAN 202302



**UR016G**

Offset bike handle



**UR017G**

Loop handle



**Lightweight design**

Model:  
UR016G **5.3 kg**

with battery BL4050F  
without Cutting tool and Shoulder strap



**Multi functional control panel: near right hand position for easy access and operation**

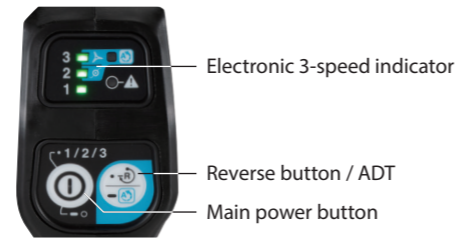

**Operation mode can be selected to suit the type of blade.**



**Run Time** with Plastic blade and BL4040

High Med Low  
**260 / 135 / 90 min**

on a single full battery charge/ No load

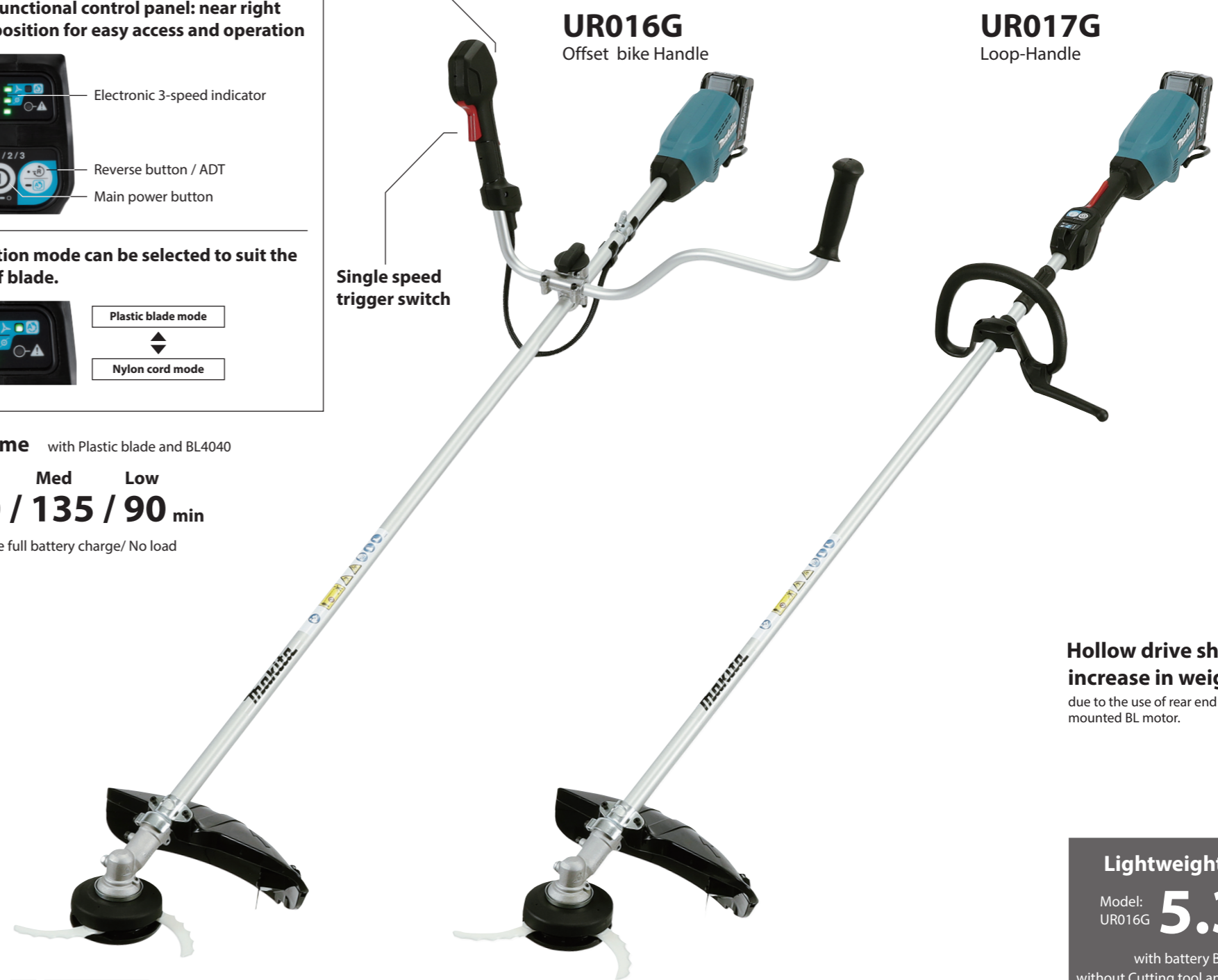

## BL MOTOR

### Rear end mounted BL motor

makes the tool weight balance similar to engine grass trimmers



### Hollow drive shaft minimizes increase in weight

due to the use of rear end mounted BL motor.



### Lightweight design

Model: UR016G **5.3 kg**

with battery BL4050F  
without Cutting tool and Shoulder strap

## ADT

### Automatic torque Drive Technology

Automatically changes the cutting speed according to grass density.

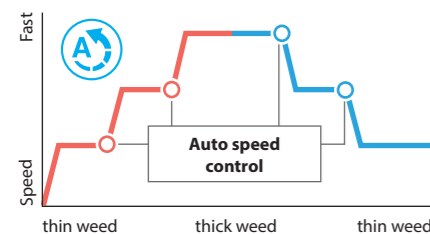

## AFT

### Active Feedback sensing Technology

Torque limiter turns the motor off if the tool is suddenly forced to lock

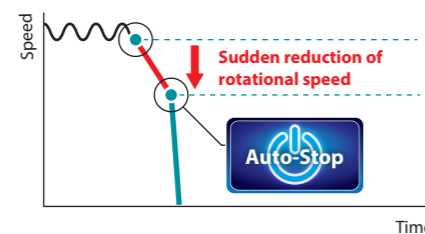

## XPT

### eXtreme Protection Technology

Enhanced Dust and Drip-proof Performance ensure reliable operation even under bad weather

### IPX4-compatible



### Grass tangle removing function

Reverse switch for clearing entangled weeds and grass from cutting head



### Toolless handle lock mechanism for good portability

