



# Cordless Combination Hammer HR007G 28 mm (1-1/8")



 Adapted for SDS-PLUS bits

**XGT**  
**40V** LI-ION  
**max**

Impact energy  
[EPTA-Procedure 05/2009]

**3.0**  
Joule

## Cordless 28mm D-handle combination hammer

Work speed  
ø10.5mm (3/8")

**6.1** sec

Battery: BL4040

**3 mode**

- Rotation
- Rotation + Hammering
- Hammering



### Anti-Vibration Technology

Equipped with anti-vibration main handle and side handle to reduce vibration to operator's hands for less hand and arm fatigue from long continuous operation.

**AVT** Vibration level at main handle  
**8.6 m/s<sup>2</sup>**



Work speed		
Drilled holes to a depth of 60mm (2-3/8") at 8kg pressing load Concrete with compressive strength of 40N/mm <sup>2</sup> BL4040 / on full battery charge		
ø10.5mm (3/8")	ø12.5mm (1/2")	ø16.0mm (5/8")
<b>6.1 sec</b>	<b>8.6 sec</b>	<b>12 sec</b>

### AFT Active Feedback sensing Technology

turns the motor off if bit rotation is suddenly forced to stop.

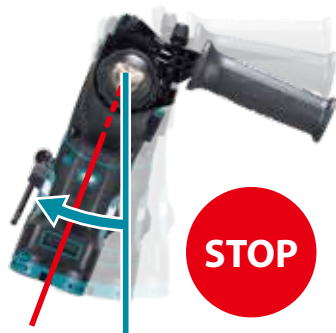

### AWS Auto-start Wireless System

connects to compatible vacuum cleaner with Bluetooth. The vacuum cleaner automatically runs while the switch is on.

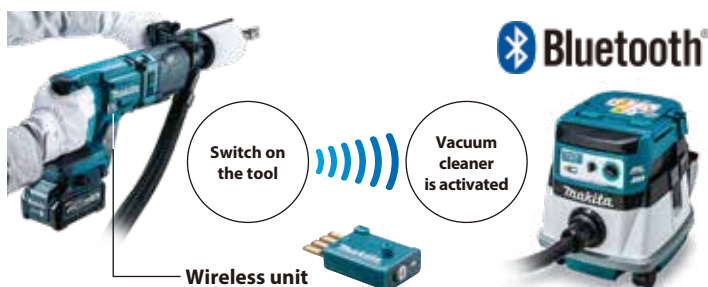

# High efficiency

using 40Vmax XGT battery as the power source.



with Dust extraction system DX15

## XPT

eXtreme Protection Technology



Adapted for SDS-PLUS bits

- 3-mode operation
- Rotation
  - Rotation + Hammering
  - Hammering

Single LED job light



Reversing switch





## Accessories

### Dust extraction system

**DX15** Maximum bit size attachable:  $\varnothing 28\text{mm} \times 260\text{mm}$



Drilling depth can be adjusted



Position adjustable Dust collection inlet



Transparent Dust case

Equipped with Filter cleaning mechanism



**HEPA filter**



**Dust case set**  
Part No. 199586-0



**Filter set**  
Part No. 199557-7



**Filter set**  
Part No. 195173-3



**Hook set**  
Part No. 191W90-3



## Portable Power Pack

**PDC01**

Powered by up to four 18V LXT batteries



**PDC1200**



Equipped with built-in battery cells



Charger: DC4001  
Charging time: 6hours

**Adapter set (40Vmax)**  
Part No. 191N62-4



## Charging Time

40Vmax Li-ion	Fast Charging	
	DC40RA	DC40RC
*BL4020 2.0Ah	22 min	30 min
*BL4025 2.5Ah	28 min	38 min
*BL4040 4.0Ah	45 min	67 min
BL4050F 5.0Ah	50 min	85 min

\*1 Recommended battery

The weight may differ depending on the attachment(s), including the battery cartridge. The lightest and heaviest combination, according to EPTA-Procedure 01/2014, are shown in the table. Items of standard equipment and specifications may vary by country or area.

## Cordless Combination Hammer

**HR07G** 28 mm (1-1/8") Adapted for SDS-PLUS bits

- Variable Speed
- Dust Collection
- Brake
- Built-in Job Light
- Reversing
- Carrying Case
- Adapted for SDS-PLUS bits
- Torque Limiter
- Constant Speed

Impact Energy Capacity	EPTA-Procedure 05/2009: 3.0 J
Blows Per Minute (BPM)	Concrete / Steel / Wood / Core Bit / Diamond Core Bit (Dry Type): 28 / 13 / 32 / 54 / 65 mm (1-1/8" / 1/2" / 1-1/4" / 2-1/8" / 2-9/16")
No Load Speed (RPM)	0 - 5,000
Vibration Level	0 - 980
	Hammer Drilling into Concrete: 7.5 m/s <sup>2</sup>
	Chiselling Function w/ Side Grip: 8.6 m/s <sup>2</sup>
	Drilling into Metal: 2.8 m/s <sup>2</sup>
Sound Pressure Level	94 dB(A)
Sound Power Level	105 dB(A)
Dimensions (L x W x H)	w/ BL4020 / BL4025: 458 x 101 x 234 mm (18 x 4 x 9-1/4")
	w/ BL4040: 473 x 101 x 240 mm (18-5/8 x 4 x 9-1/2")
Net weight	3.8 - 4.8 kg (8.4 - 10.6 lbs.)

Standard Equipment : Side Grip, Depth Gauge, Battery, Charger, Cloth, Grease vessel

**Makita Corporation**

3-11-8 Sumiyoshi-cho, Anjo, Aichi, 446-8502 Japan

PRINTED IN JAPAN 202110