



Cordless Rotary Hammer HR006G 52 mm (2-1/16")



 Adapted for SDS-MAX bits



40V_{max} LXT + **40V_{max} LXT**



Cordless / More powerful than corded tools

Impact energy
[EPTA-Procedure 05/2009]
21.4
Joule



40V_{Li-ion} max + 40V_{Li-ion} max

XGT X2
80V_{max}



Impact energy
[EPTA-Procedure 05/2009]

21.4
Joule



Drilling speed*

about **27%**
UP

Work amount*
[Drilling]

about **44** pcs

Drilling speed

HR006G	127
AC tool	100

slow speed fast

*on a full battery charge / with battery: BL4040 x2 / concrete with compressive strength of 40N/mm² / drilled holes to a depth of 140 mm / Ø18mm

2
mode

Rotation +
Hammering



Hammering

A

AVT

ANTI VIBRATION TECHNOLOGY

Vibration level at main handle

8.5 m/s²

C

A Active dynamic vibration absorber moves in the opposite direction to the drive piston to reduce vibration.

B Vibration absorbing housing isolates handle and motor.

C Damper spring absorbs impact vibrations from the drill bit.

SOFT NOLOAD

Suppression of motor speed during no-load

XPT

eXtreme Protection Technology





B

AFT Active Feedback sensing Technology

turns the motor off if bit rotation is suddenly forced to stop.



AWS Auto-start Wireless System

connects to compatible vacuum cleaner with Bluetooth. The vacuum cleaner automatically runs while the switch is on.

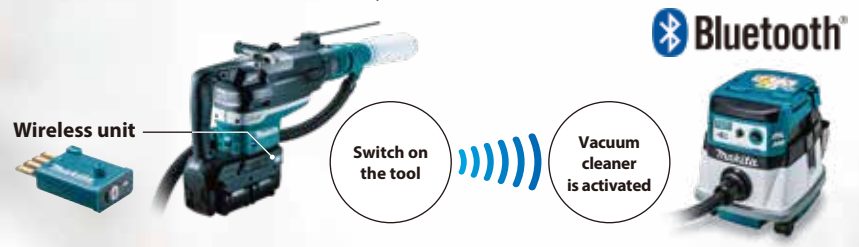

Type

Side grip



Side handle



Twin LED job lights



Variable speed control dial



BL MOTOR

40Vmax + 40Vmax

XGT X2
80Vmax

40Vmax
series
movie



40Vmax
mechanism
movie



This movie was filmed
in Japan.
Models and specs may
vary by country.

Cordless Hammer Series



Rotary Hammer
HR006G



Demolition Hammer
HM002G



XGT
40Vmax

Demolition Hammer
HM001G



Rotary Hammer
HR005G



Combination Hammer
HR001G / HR002G / HR003G / HR004G



Accessories

Dust extractor attachment set

Drilling / Hammering

Part No. 191N81-0



Drilling mode

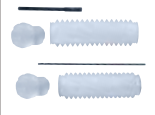

Hammering mode



Hammering

without Vacuum hose set

Part No. 199143-4

with Vacuum hose set

Part No. 199144-2

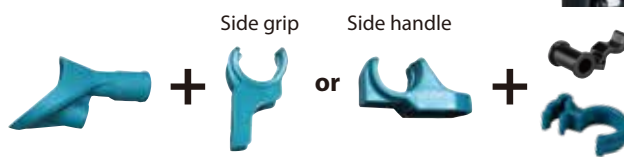

Charging Time Reference

40Vmax Li-ion	DC40RA Fast Charging		DC40RC
	BL4020 2.0Ah	BL4025 2.5Ah	DC40RB
	22min	30min	
	28min	38min	
	45min	67min	
	50min	85min	

*1 Recommended battery

Cordless Rotary Hammer

HR006G 52 mm (2-1/16") Adapted for SDS-MAX bits

- Variable Speed
- Brake
- Adapted for SDS-MAX bits
- Torque Limiter
- Constant Speed
- Soft Start
- Built-in Job Light
- Carrying Case

Impact Energy Capacity	EPTA-Procedure 05/2009: 21.4 J Concrete (w/ TCT Bit): 52 mm (2-1/16") Concrete (w/ Core Bit): 160 mm (6-5/16")
Blows Per Minute (BPM)	1,100 - 2,250
No Load Speed (RPM)	150 - 310
Sound Pressure Level	99 dB(A)
Sound Power Level	110 dB(A)
Vibration Level	Chiselling Function w/ Side Handle: 7.0 m/s ² Chiselling Function w/ Side Grip: 7.0 m/s ² Hammer Drilling into Concrete: 8.5 m/s ²
Dimensions (L x W x H)	w/ BL4040: 610 x 140 x 337 mm (24 x 5-1/2 x 13-1/4")
Net weight	12.9 - 14.3 kg (28.4 - 31.5 lbs.)

Standard Equipment: Side Handle, Side Grip, Depth Gauge, Grease vessel

The weight may differ depending on the attachment(s), including the battery cartridge. The lightest and heaviest combination, according to EPTA-Procedure 01/2014, are shown in the table.
Items of standard equipment and specifications may vary by country or area.

Makita Corporation

3-11-8 Sumiyoshi-cho, Anjo, Aichi, 446-8502 Japan

PRINTED IN JAPAN 202102